

Wi-Fi INTERFACE

Model MSZ-LN Series (MAC-567IFB-E), MAC-567IF-E, MAC-587IF-E
MSZ-AP Series (MAC-566IFB-E/MAC-567IFB2-E/MAC-577IF2-E)
MSZ-EF Series (MAC-577IF2-E) MSZ-BT Series (MAC-577IF-E)

SETUP MANUAL**KONFIGURATIONSHANDBUCH****MANUEL DE CONFIGURATION****SETUPHANDLEIDING****MANUAL DE CONFIGURACIÓN****MANUALE DI CONFIGURAZIONE****ΕΓΧΕΙΡΙΔΙΟ ΡΥΘΜΙΣΗΣ****MANUAL DE CONFIGURAÇÃO****OPSÆTNINGSMANUAL****INSTÄLLNINGSMANUAL****РЪКОВОДСТВО ЗА НАСТРОЙКА****INSTRUKCJA KONFIGURACJI****KONFIGURASJONSHÅNDBOK****ASETUSOPAS****PŘÍRUČKA PRO NASTAVENÍ****NÁVOD NA NASTAVENIE****BEÁLLÍTÁSI ÚTMUTATÓ****NASTAVITVENI PRIROČNIK****MANUALUL DE CONFIGURARE****HÄÄLESTUSJUHEND****IESTATĪŠANAS PAMĀCĪBU****SARANKOS VADOVA****PRIRUČNIK ZA UGRADNJU****UPUTSTVO ZA PODEŠAVANJE****AYAR KILAVUZU****РУКОВОДСТВО ПО НАСТРОЙКЕ****ПОСІБНИК З НАСТРОЙКИ****คู่มือการตั้งค่า**

English(EN)

Deutsch(DE)

Français(FR)

Nederlands(NL)

Español(ES)

Italiano(IT)

Ελληνικά(EL)

Português(PT)

Dansk(DA)

Svenska(SV)

Български(BG)

Polski(PL)

Norsk(NO)

Suomi(FI)

Čeština(CS)

Slovenčina(SK)

Magyar(HU)

Slovenščina(SL)

Română(RO)

Eesti(ET)

Latviski(LV)

Lietuviškai(LT)

Hrvatski(HR)

Srpski(SR)

Türkçe(TR)

Русский(RU)

Українська(UK)

ไทย(TH)

Introduction

See the manuals of the system to be connected with the Wi-Fi interface to figure out which model of the Wi-Fi interface is connectable to it.

- The figures hereafter show MAC-57/58 series as a representative.
- ATW (Air to water) is only compatible with MAC-567IF-E and MAC-587IF-E.

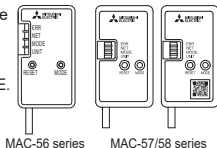

MAC-56 series

MAC-57/58 series

Contents

1. Safety precautions	1
2. Product Introduction	2
3. Setting up	3
4. LED pattern	6

1. Safety precautions

- Read all Safety Instructions before using the Wi-Fi interface.
- This manual contains important safety information. Be sure to comply with the instructions.

■ Meanings of symbols used in this manual

	Be sure not to do.
	Never touch with wet hand.
	Never splash water on the unit.
	Be sure to follow the instruction.
	Be sure to disconnect the power supply plug from the power outlet.



Warning

(Improper handling may have serious consequences, including serious injury or death.)

	■ Do not disassemble, modify, or repair by yourself (user). It can cause electric shock, fire, or injury.		■ Do not use the Wi-Fi interface nearby the medical electrical equipment or people who have a medical device such as a cardiac pacemaker or an implantable cardioverter-defibrillator. It can cause an accident due to malfunctions of the medical equipment or device.
	■ This appliance is not intended for use by persons (including children) with reduced physical, sensory or mental capabilities, or lack of experience and knowledge, unless they have been given supervision or instruction concerning use of the appliance by a person responsible for their safety.		■ Do not install the Wi-Fi interface nearby the automatic control devices such as automatic doors or fire alarms. It can cause accidents due to malfunctions.
	■ Children should be supervised to ensure that they do not play with the appliances.		■ Do not touch the Wi-Fi interface with wet hands. It can cause damage to the device, electric shock, or fire.
	■ This appliance can be used by children aged from 8 years and above and persons with reduced physical, sensory or mental capabilities or lack of experience and knowledge if they have been given supervision or instruction concerning use of the appliance in a safe way and understand the hazards involved.		■ Do not splash water on the Wi-Fi interface or use it in a bathroom. It can cause damage to the device, electric shock, or fire.
	■ Children shall not play with the appliance. Cleaning and user maintenance shall not be made by children without supervision.		■ Do not install the Wi-Fi interface by yourself (user). Improper installation may result in fire, electric shock, or injury due to fall of the Wi-Fi interface. Consult the dealer from whom you purchased the Wi-Fi interface or professional installer.



Warning

(Improper handling may have serious consequences, including serious injury or death.)

- | | |
|---|--|
|  <ul style="list-style-type: none">■ If the Wi-Fi interface is dropped or its body or cable is damaged, disconnect the power supply plug or turn the breaker OFF.
It may cause fire or electric shock. In this case, consult your dealer. |  <ul style="list-style-type: none">■ In case of an abnormal condition (such as a burning smell), stop the indoor unit and disconnect the power supply plug or turn the breaker OFF.
A continued operation in the abnormal state may cause a malfunction, fire, or electric shock. In this case, consult your dealer. |
|---|--|

Caution

(Improper handling may have consequences, including injury or damage to building.)

- | | |
|---|---|
|  <ul style="list-style-type: none">■ Do not mount the Wi-Fi interface where children can reach.
It can cause injury.■ Do not step on unstable stepstool to set up or clean the Wi-Fi interface.
It may cause injury if you fall down. |  <ul style="list-style-type: none">■ Do not use the Wi-Fi interface nearby other wireless devices, microwaves, cordless phones, or facsimiles.
It can cause malfunctions. |
|---|---|

Note

- Ensure that the Router supports the **WPA2-AES** encryption setting before starting the Wi-Fi interface setup.
- The End user should read and accept the terms and conditions of the Wi-Fi service before using this Wi-Fi interface.
- To complete connection of this Wi-Fi interface to the Wi-Fi service the Router may be required.
- This Wi-Fi interface will not commence transmission of any operational data from the system until the End user registers and accepts the terms and conditions of the Wi-Fi service.
- This Wi-Fi interface should not be installed and connected to any Mitsubishi Electric system which is to provide application critical cooling or heating.
- Please write down the model information and more in "Setting information" on the last page of **INSTALLATION MANUAL** or the instruction manual of the system to be connected with the Wi-Fi interface, when you set up this Wi-Fi interface.
- Before transferring or disposing of the Wi-Fi interface, it has to be reset to the factory default.

2. Product Introduction

No.	Item	Description
1	MODE switch	It selects modes.
2	RESET switch	It resets the system and ALL settings.
3	ERR LED (Orange)	It shows the network error state.
4	NET LED (Green)	It shows the network state.
5	MODE LED (Orange)	It shows the Access Point mode state.
6	UNIT LED (Green)	It shows the indoor unit state.

(1) MODE switch

- The MODE switch is used for selecting modes in configurations.

(2) RESET switch

- Hold down the RESET switch for 2 seconds to reboot the system.
- Hold down the RESET switch for 14 seconds to initialize the Wi-Fi interface to the factory default.

When the Wi-Fi interface is reset to the factory default, ALL the configuration information will be lost. Take great care in implementing this operation.

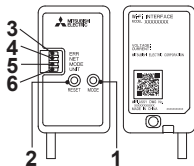

3. Setting up

3-1. Initial state

Turn on the breaker of the air conditioner or the ATW unit. After LED indication enters the initial state shown on right, the Wi-Fi interface can be paired with the Router.
Refer to 4. LED pattern when LED indication does not enter the initial state.
Note: It may take a few minutes to enter the initial state.

Initial state

ERR	OFF
NET	OFF
MODE	OFF
UNIT	Flashing

3-2. Selecting a mode

The Wi-Fi interface has to be paired with the Router in order for communication between the indoor unit and MELCloud to begin. There are 3 methods of pairing the Wi-Fi interface with the Router:

- WPS-PUSH mode
- Access Point mode
- WPS-PIN mode (MAC-56 series only)

The mode to be set depends on whether your Router has the WPS button.

Please use the pairing mode most suitable for your system.

Follow the instructions below to set the pairing mode with the MODE switch.

Set up the Wi-Fi interface and the Router again from 3-2. when the Router has been replaced.

■ WPS-Push mode <For a router with a WPS button>

[To enter the mode]

Hold down the MODE switch for 2 seconds.

[LED indication]

When WPS-Push is enabled on the Wi-Fi interface, the MODE LED starts flashing orange (every second).

[To cancel the mode]

Hold down the RESET switch for 2 seconds to return to the initial state described in 3-1.

■ Access Point mode <For a router without a WPS button and to set up with a smart phone>

[To enter the mode]

Hold down the MODE switch for 7 seconds.

[LED indication]

When Access Point mode is enabled on the Wi-Fi interface, the MODE LED starts flashing orange (every 5 seconds).

[To cancel the mode]

Hold down the MODE switch for 7 seconds again and ensure that the MODE LED is no longer flashing.

■ WPS-PIN mode <MAC-56 series only>

[To enter the mode]

Hold down the MODE switch for 14 seconds.

[LED indication]

When WPS-PIN is enabled on the Wi-Fi interface, the MODE LED starts flashing orange (every 0.5 seconds).

[To cancel the mode]

Hold down the RESET switch for 2 seconds to return to the initial state described in 3-1.

In any mode, the NET LED will flash when the Wi-Fi interface is connected to the Router.

3-3. Setting up in WPS-PUSH mode

1. Make sure that the LED indication is as shown below.
Push WPS button of the Router within 2 minutes after the mode selection in 3-2. has completed.
The WPS-PUSH mode will return to initial state in 3-1. if WPS button is not pressed for 2 minutes.

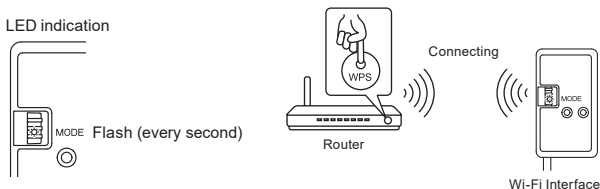

2. LED indication will be as shown below when connection between the Router and Wi-Fi interface is completed and connection to MELCloud starts.
Note: LED indication will return to initial state in 3-1. if the connection fails.

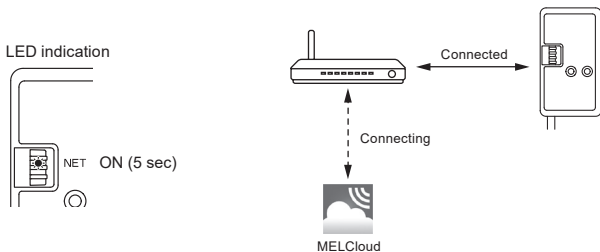

3. LED indication will be as shown below when the connection is completed.
Note: It may take several minutes to show the indication below.

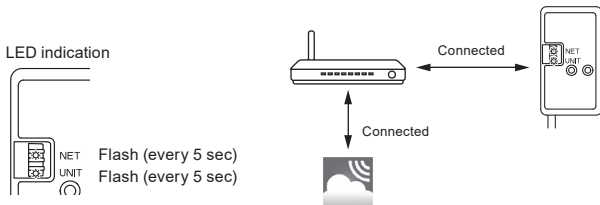

Main Causes that WPS failed are as follows.

Communication distance (from the Wi-Fi interface to Router), Router settings (encryption, authentication, limit of connections, etc.)

For more information, refer to Troubleshooting in 4. LED Pattern.

3-4. Setting up in Access Point mode

Complete the setting up in the Access Point mode within 10 minutes. (MAC-57/58 series only)

1. Make sure that the LED indication is as shown below.

On the Wi-Fi Setting Screen on your smartphone, select SSID and enter KEY, which are printed on the information label.

Notes:

- The attachment position of the information label varies depending on the model.
- It may take time to show the indication below.
(About 30 seconds for air conditioner, 60 seconds for ATW unit)
- Check Wi-Fi setting of your smartphone if SSID does not appear on it.
- Enter KEY again if SSID appears on your smartphone, but it cannot connect to the Wi-Fi interface.

LED indication

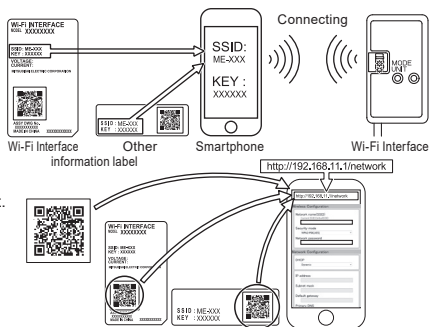
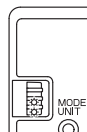

2. Perform one of the following:

- Scan the matrix barcode on the right.
- Scan the matrix barcode on the information label.
- Type the URL (<http://192.168.11.1/network>) in the web browser.

3. In the displayed window, select Dynamic in DHCP (*1) and enter the information of Router, then tap the Submit button.

Notes:

- If you want to use Static, select Static in DHCP (*1) and enter the information of Router and network, then tap the Submit button.
- LED indication will return to initial state in 3-1. if the connection fails.

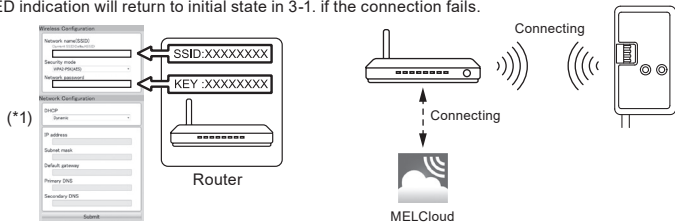

4. LED indication will be as shown below when the connection is completed.

Note: It may take several minutes to show the indication below.

(If the indication does not change, push RESET switch for more than 14 seconds, to restart the setup from 3-1.)

LED indication

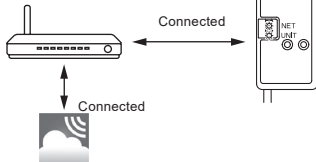
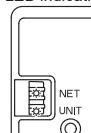

3-5. Setting up WPS-PIN mode (MAC-56 series only)

1. Before using WPS-PIN mode, the PIN code of the Wi-Fi interface needs to be set on the Router. Refer to Router's manual to enter the PIN.
2. Push MODE switch for 14 seconds and release to set WPS-PIN mode.
3. NET and UNIT LEDs flash (every 5 sec) when the connection is completed.

Notes:

- Please make sure that the Router supports WPS-PIN mode.
Not all Routers supports WPS-PIN mode.
- Push RESET switch for 2 seconds to reset the Wi-Fi interface if LED indication does not change after 5 minutes.

Wi-Fi INTERFACE
MODEL: XXXXXXXX

PIN : XXXXXX

4. LED pattern

☀ : ON ○ : OFF ⚙ : Flashing

● Software initializing				
Description	ERR (Orange)	NET (Green)	MODE (Orange)	UNIT (Green)
Firmware updating	○	☀	☀	○
Firmware downloading	○	⚙ (every second)	⚙ (every second)	○
Reset to the factory default	○	○	☀	☀
● Wireless setting				
Description	ERR (Orange)	NET (Green)	MODE (Orange)	UNIT (Green)
Access Point mode activated	○	○	⚙ (every 5 sec)	⚙ (every 5 sec)
WPS-PUSH mode activated	○	○	⚙ (every second)	○
WPS-PIN mode activated (MAC-56 series only)	○	○	⚙ (every 0.5 sec)	○
Pairing process via WPS completed	○	☀ (5 sec)	○	○
Pairing process via WPS failed	☀ (5 sec)	○	○	○
● Connection to MELCloud in progress				
Description	ERR (Orange)	NET (Green)	MODE (Orange)	UNIT (Green)
Communicating with MELCloud, and starting up indoor unit communication	○	☀ (*1)	○	☀
Communicating with MELCloud, and communicating with indoor unit	○	☀ (*1)	○	⚙ (every 5 sec)

(*1) Details of flash pattern

- Every 0.5 sec: Searching for MELCloud.
- Every second: Registering the information of the Wi-Fi interface to MELCloud.
- Every 5 sec: Communicating with MELCloud.

Troubleshooting

☀ : ON ○ : OFF ⚙ : Flashing

Description	ERR (Orange)	NET (Green)	MODE (Orange)	UNIT (Green)
Connection to MELCloud established, and Connection to indoor unit failed	○	☀	○	○
Connection to Router failed, and connection to indoor unit established	○	○	○	☀
Connection to Router failed, and starting up indoor unit connection	○	○	○	☀
Connection to Router failed, and connection to indoor unit failed	○	○	○	○
Connection to MELCloud failed, and Connection to indoor unit established	☀ (*2)	☀	○	☀
Connection to MELCloud failed, and starting up indoor unit connection	☀ (*2)	☀	○	☀
Connection to MELCloud failed, and connection to indoor unit failed	☀ (*2)	☀	○	○

Check the following first in the cases listed in the above table.

Check the following, and pair the Wi-Fi interface and the Router according to 3-2. Selecting a mode.

- Make sure that the communication distance is not too far between the Wi-Fi interface and the Router.
- Make sure that the Router uses WPA2-AES encryption.
- Make sure that the number of connected devices to the Router does not exceed the limit.

(*2) Details of flash pattern

- Every 0.5 sec: IP address setting is invalid.

Make sure that DHCP is enabled, or check IP address settings of the Wi-Fi interface.

If both settings are correct but still the problem persists, push RESET switch for more than 14 seconds to restart the setup from 3-1.

- Every second: DNS setting is invalid.

Check DNS settings of the Router, or check DNS address settings of the Wi-Fi interface or improve the radio wave environment.

Push RESET switch for 2 seconds.

- Once every 5 sec: Not communicating with MELCloud properly.

Push RESET switch for 2 seconds.

- Twice every 5 sec: Not connected to MELCloud.

Check if the Router is connected to the Internet.

Push RESET switch for 2 seconds.

- Three times every 5 sec: Not communicating with MELCloud. (Quick communication error)

Push RESET switch for 2 seconds.

[About trademarks]

- WPS is the connection via Wi-Fi Protected Setup.
- “Wi-Fi®”, “Wi-Fi Protected Setup™”, “WPA2™” are trademarks or registered trademarks of the Wi-Fi Alliance.

For Declaration of Conformity, please go to the website below.
<http://www.mitsubishielectric.com/ldg/ibim/>

For MELCloud User Manual, please go to the website below.
<https://www.melcloud.com/Support>

The Wi-Fi Interface (except for MAC-56 series) uses Open Source Software. To view the Open Source software licence(s), please go to the following website whilst connected to the Wi-Fi Interface during the Access Point mode. <http://192.168.11.1/license>

This product is designed and intended for use in the residential,
commercial and light-industrial environment.

mitsubishi electric consumer products (thailand) co., ltd
amata city chonburi 700/406 moo 7, tambon don hua roh, amphur muang, chonburi 20000,
thailand

mitsubishi electric air conditioning systems manufacturing turkey joint stock company.
manisa osb 4.kisim kecilikoyosb mah.
ahmet nazif zorlu bulvari no:19 yunusemre - manisa.

mitsubishi electric corporation

head office: tokyo building, 2-7-3, marunouchi, chiyoda-ku, tokyo 100-8310, japan

JG79Y755H04